



## Tips & Tricks

### How to Delete a Client on your mobile device

You can delete a client from REALM using the following steps on a mobile device:

1. Select **Contacts**  from the menu bar.
2. Select the **layer menu**  and choose the contact type – active, inactive, or disabled – by activating the appropriate bullet. Select the X (or swipe down) to close the layer.
3. From the list, select the client you would like to delete.
4. Select the **menu icon** .
5. Select **Delete** from the pop-up menu.

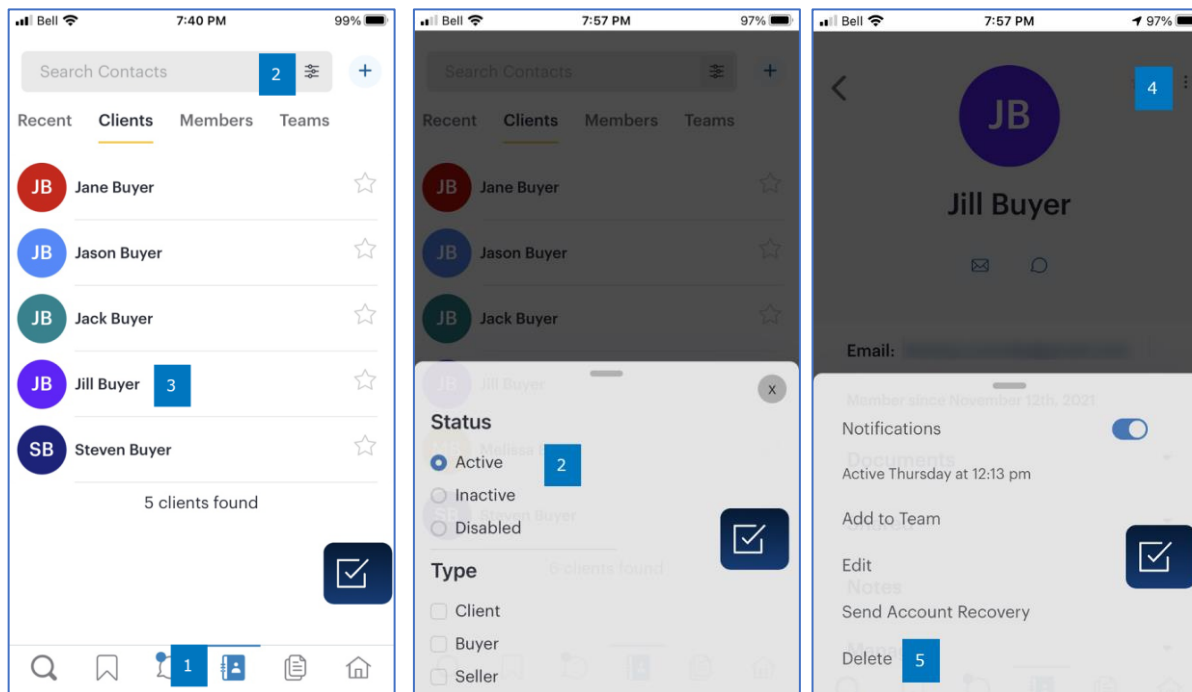

6. A confirmation window will appear, select **Delete**.

If you have any questions, please contact us at [Help@REALMmlp.ca](mailto:Help@REALMmlp.ca).

